

## UNDERWATER HYDRAULIC IMPACT WRENCH SY-IW16350C



### SPECIFICATIONS

<b>Capacity</b>	1" Square Drive
<b>Torque</b>	500 -2500 ft lbs / 680-3400 Nm
<b>Flow Range</b>	7-12 gpm / 26-45 lpm
<b>Working Pressure</b>	1500-2000 psi / 105-140 bar
<b>Full Relief Setting</b>	2250 psi / 155 bar
<b>Weight</b>	26 lbs / 12 kg
<b>Length</b>	15" / 38 cm
<b>Width</b>	4.5" / 11 cm
<b>Hydraulic Ports</b>	-8 SAE O-ring
<b>Connect Size and Type</b>	3/8" Male Pipe Adapter
<b>Couplers</b>	(See Ordering Information)
<b>Hose Whips</b>	No (See Accessories)



The Stanley **IW16** is a heavy duty 1" square drive impact wrench designed for the toughest underwater bolting applications. Powered by a Stanley integral Hyrevz motor, the **IW16** has a durable swing hammer impact mechanism with adjustable impact intensity from 500 to 2500 ft lbs (680 to 3400 Nm) of torque. Designed to run from a wide range of hydraulic circuits. "D" style grip handle with multi-position assist handle and hi-visibility yellow paint is standard.

### FEATURES

- Integral Stanley Hyrevz gear motor produces high torque
- Stainless Steel spools and fasteners
- Forward-Reverse with variable speed
- "D" style grip handle with inside trigger
- Feathering on/off trigger for precise control
- Adjustable impact intensity
- 2500 ft lbs/3400 Nm of maximum impact torque
- Durable swing hammer mechanism
- Cast-in lifting eye



## UNDERWATER HYDRAULIC IMPACT WRENCH SY-IW16350C

# ORDERING INFORMATION

### PART NUMBER

**IW16350** Impact Wrench, Underwater, 1" Square Drive, less couplers

**IW1635001** Impact Wrench, Underwater, CE, 1" Square Drive, with couplers

### ACCESSORIES

**03971** Flush-Face Coupling Set, 3/8" NPT

**03974** Flush-Face Coupling Set, 1/2" NPT

**06830** Hose Whip 18" long, -8 SAE x 1/2" NPT

**31848** Dual Hose, 50' x 1/2", with couplers

**31972** Dual Hose, 25' x 1/2", with couplers

**58633** Twinned Hose, 25' x 1/2", with couplers

**58634** Twinned Hose, 50' x 1/2", with couplers

**31203** Extension, 10", 1" Drive

**33276** Socket Retainer Pin, 1" Square Drive Socket

**33277** Socket Retainer Ring, 1" Square Drive Socket

When hydraulic hose exceeds 100' (30.4 m) in length, increase I.D. of both pressure and return hose. For more information, consult Stanley Hydraulic Tools.

### IMPORTANT

To fill out a Product Warranty Recording form and for information on your warranty visit [stanleyhydraulic.com](http://stanleyhydraulic.com) and select the Warranty tab.



**Note:** The warranty recording form must be submitted to validate the warranty.

# UNDERWATER HYDRAULIC IMPACT WRENCH SY-IW16350C

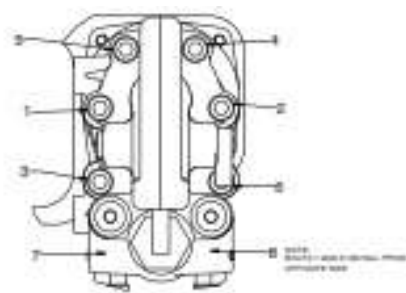

**CAUTION**  
 Make sure the correct capscrew is used in the correct location

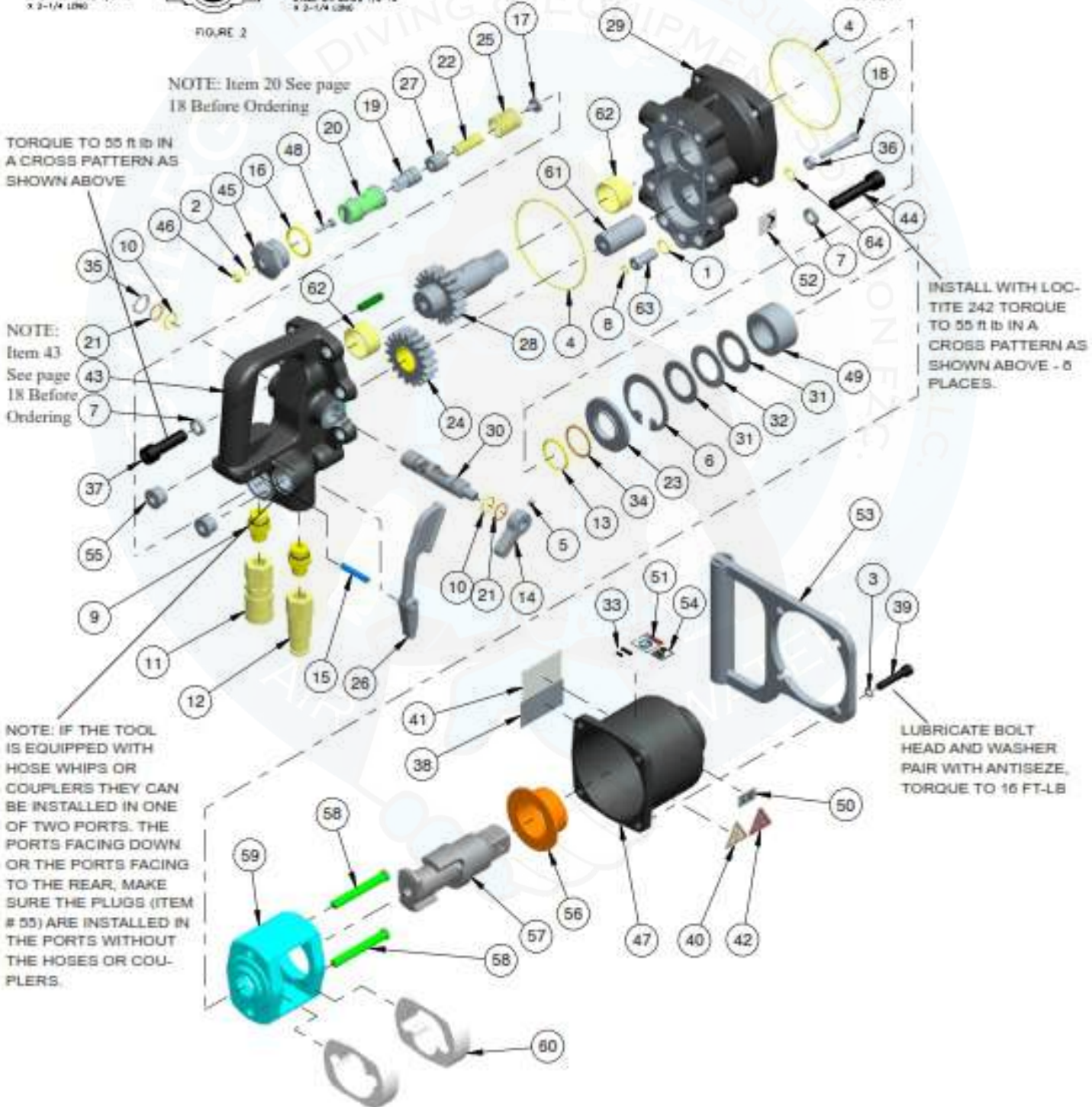
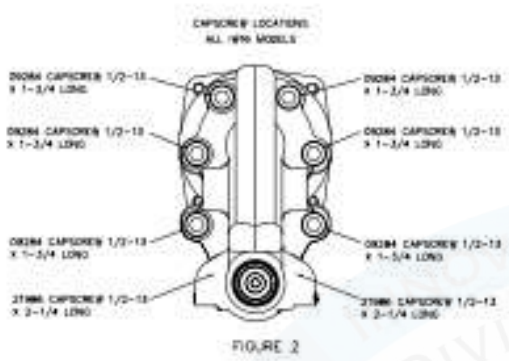

## UNDERWATER HYDRAULIC IMPACT WRENCH SY-IW16350C

ITEM NO.	PART NO.	QTY	DESCRIPTION
1	00016	1	O-RING*
2	00026	1	O-RING*
3	73687	4	LOCKWASHER PAIR 5/16" I.D. NORD-LOCK
4	00255	2	O-RING*
5	00580	1	SETSCREW 1/4-20 X 1/4
6	00663	1	RETAINING RING
7	00697	8	LOCKWASHER 1/2" I.D
8	00717	1	O-RING*
9	00936	2	ADAPTER -8 (1/2) SAE X 3/8 NPT
10	01211	2	O-RING*
11	03972	1	COUPLER,3/8FEM. (SET 03971)
12	03973	1	COUPLER,3/8MALE (SET 03971)
13	04888	1	O-RING*
14	04939	1	LEVER
15	05965	1	ROLL PIN
16	06533	1	O-RING*
17	07982	1	SPRING REST
18	07984	1	RELIEF ADJUSTMENT SCREW
19	07986	1	RELIEF SEAT
20	73046	1	SPOOL (See page 18 before ordering)
21	08015	2	BACK-UP RING*
22	08122	1	COMPRESSION COIL SPRING
23	08125	1	SEAL BACK-UP WASHER*
24	08128	1	IDLER GEAR ASSY
25	08131	1	COMPRESSION COIL SPRING
26	08133	1	TRIGGER
27	08135	1	RELIEF POPPET
28	08136	1	MAIN SHAFT
29	08137	1	MOTOR HOUSING ASSY (INCLUDES ITEMS 61 THRU 64)
30	08139	1	REVERSING SPOOL
31	08147	2	THRUST WASHER
32	08148	1	THRUST BEARING
33	08153	1	NAME TAG - IW16
34	08180	1	BACK-UP RING*
35	09275	1	RETAINING RING EXTERNAL
36	09277	1	HEX NUT 5/16-18UNC
37	09284	6	HSCHS 1/2-13 X 1-3/4
38	09612	1	GENERAL CAUTION STICKER
39	09625	4	HSCHS 5/16-18 X 1-1/2
40	11207	1	CIRCUIT TYPE "D" STICKER
41	12412	1	DANGER STICKER - ELECTRICAL
42	12535	1	CIRCUIT TYPE "E" STICKER

ITEM NO.	PART NO.	QTY	DESCRIPTION
43	73167	1	VALVE HANDLE ASSY (INCLUDES ITEMS 55 and 62). SEE PAGE #18 BEFORE ORDERING
44	21986	2	HSCHS 1/2-13 X 2-1/4
45	22063	1	SPOOL CAP
46	22064	1	ROD WIPER*
47	24682	1	HAMMER CASE, LAND (INCL ITEM 56)
	24758	1	HAMMER CASE U/W MODIFIED (INCL BUSHING72762)
48	23678	1	HEADED PUSH PIN
49	23817	1	THRUST SPACER
50	28323_	1	1 CE STICKER
51	28788	1	STICKER - MANUAL
52	30136	1	ROTATION DIRECTION STICKER
53	32087	1	ASSIST HANDLE
54	66305	1	GUARANTEED SOUND POWER LEVEL 116 dBA
55	350237	2	HOLLOW HEX PLUG - 8 SAE
56	21010	1	BUSHING
	21011	1	BUSHING (UNDERWATER)
57	24678	1	ANVIL
58	24680	2	HAMMER PINS
59	24679	1	HAMMER FRAME (INCLUDES ITEM 58 PINS)
	72840	1	HAMMER FRAME ONLY
60	24677	2	HAMMER
61	08123	1	IDLER SHAFT
62	08146	2	BUSHING
63	07995	1	INSERT
64	03252	1	O-RING
	23134	1	STANDARD MECHANISM ASSY (INCL ITEMS 47, & 56 THRU 60)
	24757		UNDERWATER MECHANISM (INCL ITEMS 47 & 56 THRU 60)
	56725	2	HOSE ASSY for IW16150S (NOT PICTURED)
	66727	2	HOSE ASSY for IW16150BN (NOT PICTURED)
	47438	1	COUPLER SET FOR IW16150BN

### SEAL KIT (P/N-09602)



\* DENOTES PART IN SEAL KIT

## UNDERWATER HYDRAULIC IMPACT WRENCH SY-IW16350C

# Contact us

 29th Street, Amman Road, Behind Al Huraiz Est. For Industry,  
Al Qusais, Industrial Area – 1,  
Dubai, United Arab Emirates

-  Tel : 009714 2580533 
-  Fax : 042516664 
-  UAE : 00971505648178 
-  UK : 00447951966260 

-  Website : [www.synergiequipment.com](http://www.synergiequipment.com)
-  Email : [ram@synergiequipment.com](mailto:ram@synergiequipment.com)
-  For Sale : [info@synergiequipment.com](mailto:info@synergiequipment.com)

